

Nominal Size	Made from SDR	WPR	Approx. Dimensions	
			A	B
8	7	200	4	8.625
	9	160		
	11	100		
	17	65		
10	7	200	4	10.75
	9	160		
	11	100		
	17	65		
12	7	200	4	12.75
	9	160		
	11	100		
	17	65		
14	7	200	4	14
	9	160		
	11	100		
	17	65		
16	7	200	4	16
	9	160		
	11	100		
	17	65		
18	7	200	4	18
	9	160		
	11	100		
	17	65		
20	7	200	4	20
	9	160		
	11	100		
	17	65		
22	7	200	4	22
	9	160		
	11	100		
	17	65		
24	7	200	4	24
	9	160		
	11	100		
	17	65		

NOTES
1. Tolerances +/- 2°
2. Angle toleranes +/- 2.0°
3. Made from HDPE size specific pipe
4. Follow industry standard fusion procedures
5. Follow industry standard quality procedures
6. Custom design available
7. If specific dimensions needed, please call
8. Larger sizes available upon request
9. WPR based on PE 4710 for water at 73° F
10. Ends counterbored upon request

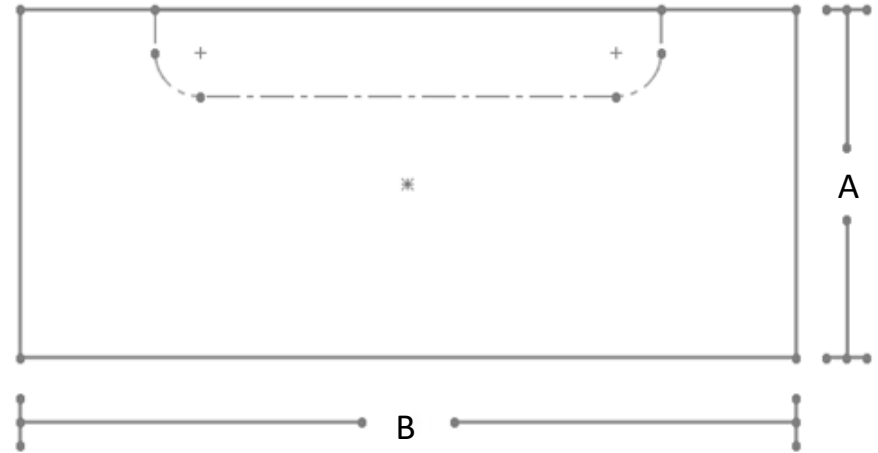

	<b>End Cap</b>
	Fabricated by <b>HDPE PRO FITTINGS</b>
1910 Rankin Rd., Houston, TX 77073	PH# 281-951-2626